

敬啟者：

路政署  
工程合約編號 HY/2021/04  
有關寶馬山行人通道系統之施工通告

本公司，必高工程有限公司，為上述路政署工程合約編號 HY/2021/04「寶馬山行人通道系統」之總承建商。此工程旨為本區居民提供一個安全便捷的行人系統，連接由炮台山港鐵站至北角半山慧翠道即樹仁大學及一帶之上坡地區，以便利當區市民往返地勢陡斜的居所或學校。

為配合工程需要，承建商將於二零二二年八月下旬起，圍封慧翠道部份行人道以進行建造自動行人道、扶手電梯及加裝相關上蓋的工程，直至另行通知。封路期間可使用替代路線通過封閉區域。(詳情請見附圖)

於施工期間，本公司將會實施一系列措施盡力減低工程對貴 業戶/用戶的影響。如有任何意見或查詢，歡迎致電本工程諮詢熱線 6317 6597 或 6508 8071 與公共關係主任鄭敏儀小姐聯絡。

如因上述工程安排引致不便，本公司謹此致歉。

必高工程有限公司

日期：二零二二年八月十七日

副本抄送：路政署  
科進顧問（亞洲）有限公司

— 謝孟軒先生 (手送文件)  
— 羅家信先生 (手送文件)

**NOTES:**

- All temporary traffic arrangements should be carried out in accordance with the Traffic Management and Control of Road Works Fifth Issue, 2017 by Highways Department.
- Street furniture being removed temporarily should be reinstated after works, if necessary.
- The exact locations and dimensions of the proposed traffic signs might be subject to the ground conditions and subject to the agreement with HKFP/PAHO during TTA implementation.
- For any dimension not indicated in the drawing, the size of works area and minimum clear width to be maintained should be measured by scale.
- Cycle track to be resumed on Saturday, Sunday and Public Holiday.

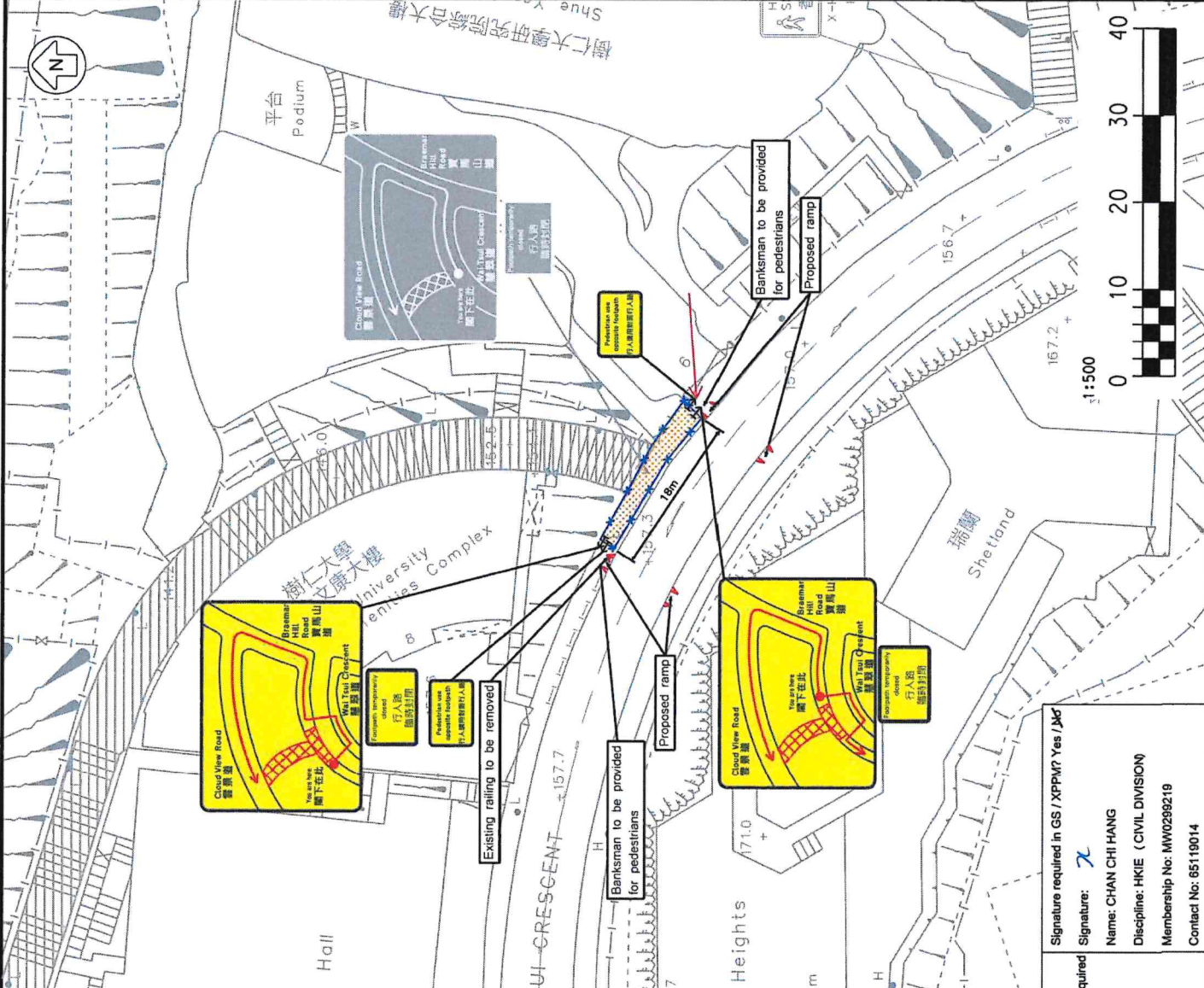
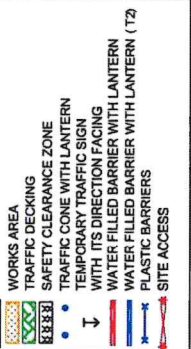

**(13) For TD / Police use:**  
 Agreed     Not agreed  
 Comments:

Signature required in GS / XPPM? Yes / No  
 Signature:   
 Name: CHAN CHI HANG  
 Discipline: HKIE (CIVIL DIVISION)  
 Membership No: MW0298219  
 Contact No: 65119014

(1) XPM5 Plan ID:	D1		
(2) Project Office:	路政署 Highways Department Braemar Hill Pedestrian Link		
(3) Contract No:	HY2021/04		
(4) Engineer:			
(5) Contractor:	必高工程		
(6) Traffic Consultant:	Nolan Consultants Ltd. 路蘭顧問有限公司		
(7) TMLG meeting date:			
(8) Drawing No: HY2021/04/WATSC/003 Temporary Traffic Arrangement at Wai Tsui Crescent			
Date:	Scale: 1:500 (A3) Case: Items:		
Designed	Drawn	Checked	Approved
Date:	Date:	Date:	Date:
Rev	Amendment		
(9) TTA Particulars:			
(A) Temp. NSR:	<input type="checkbox"/> 08-10/17-19	<input type="checkbox"/> 7-19	<input type="checkbox"/> 7-24
Net duration:	months / weeks / days	months / weeks / days	months / weeks / days
(B) Temp. PIS Closure:	<input type="checkbox"/> Non-metered		
<input type="checkbox"/> PIS meter nos.:	<input type="checkbox"/> Metered:		
Net duration:	months / weeks / days		
(C) Temp. ALZMRT:	<input type="checkbox"/> MRT		
Net duration:	months / weeks / days		
(D) Temp. Veh. Length prohibition:	<input type="checkbox"/> >7m	<input type="checkbox"/> >8m	
Net duration:	months / weeks / days	months / weeks / days	
(E) Temp. Speed Limit (km/h):	<input type="checkbox"/> 50	<input type="checkbox"/> 70	
Net duration:	months / weeks / days	months / weeks / days	
(F) Implementation hours / days of week:	0800-1800		
Net duration:	<input type="checkbox"/> 10-16	<input checked="" type="checkbox"/> 22-06	<input type="checkbox"/> Monday to Saturday
Days of week:	months / weeks / days	months / weeks / days	months / weeks / days
(G) Others / Remarks:			
<input type="checkbox"/> Loading / unloading would be carried out within parking meter. (Parking fee will be paid).			
(10) Traffic Assessments:	<input type="checkbox"/> TIA	<input type="checkbox"/> Junction Capacity	<input type="checkbox"/> Queue Length Report ref:
	<input type="checkbox"/> Swept Path	<input type="checkbox"/> Others:	
(11) Anticipated Programme:	Start: April 2022    End: May 2022		
Duration of works:	1	months / weeks / days	
(12) Remarks:			
<input type="checkbox"/> For Extension / re-endorsement, reason:			
<input type="checkbox"/> Last meeting / approval date:			
<input type="checkbox"/> Others:			